

KRP

Maniglia a ripresa Adjustable clamping lever / Manija ajustable



Descrizione

Perno in acciaio zincato filettato.
Threaded zinc plated steel stud.
Perno de acero galvanizado roscado.

Materiale

Tecnopolimero nero rinforzato con fibre di vetro, finitura opaca.
Black thermoplastic, glass fiber reinforced, mat.
Termoplástico negro reforzado con fibra de vidrio, acabado mate.

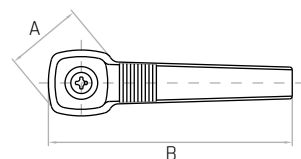
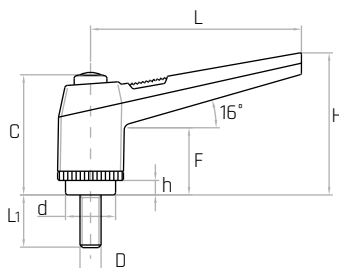

Codice	Modello	L mm	C mm	A mm	B mm	H mm	F mm	d mm	h mm	L1 mm	D	Peso gr.
6355610	KRP/42 M4x20	42	29	19	50	32	17	12	3	20	M4	11
6355620	KRP/42 M5x20	42	29	19	50	32	17	12	3	20	M5	13
6355630	KRP/42 M5x30	42	29	19	50	32	17	12	3	30	M5	14
6355635	KRP/42 M6x15	42	29	19	50	32	17	12	3	15	M6	14
6355640	KRP/42 M6x20	42	29	19	50	32	17	12	3	20	M6	15
6355650	KRP/42 M6x30	42	29	19	50	32	17	12	3	30	M6	16
6356610	KRP/63 M5x20	63	39	25	73	43	21	15	4	20	M5	24
6356615	KRP/63 M6x15	63	39	25	73	43	21	15	4	15	M6	26
6356620	KRP/63 M6x20	63	39	25	73	43	21	15	4	20	M6	28
6356625	KRP/63 M6x25	63	39	25	73	43	21	15	4	25	M6	29
6356630	KRP/63 M6x30	63	39	25	73	43	21	15	4	30	M6	30
6356640	KRP/63 M6x40	63	39	25	73	43	21	15	4	40	M6	31
6356660	KRP/63 M8x15	63	39	25	73	43	21	15	4	15	M8	32
6356665	KRP/63 M8x20	63	39	25	73	43	21	15	4	20	M8	33
6356670	KRP/63 M8x25	63	39	25	73	43	21	15	4	25	M8	34
6356675	KRP/63 M8x30	63	39	25	73	43	21	15	4	30	M8	36
6356680	KRP/63 M8x35	63	39	25	73	43	21	15	4	35	M8	37
6356685	KRP/63 M8x40	63	39	25	73	43	21	15	4	40	M8	38
6356695	KRP/63 M8x50	63	39	25	73	43	21	15	4	50	M8	39
6357610	KRP/80 M8x20	80	48	30	92	54	27	19	6	20	M8	48
6357620	KRP/80 M8x30	80	48	30	92	54	27	19	6	30	M8	51
6357625	KRP/80 M8x35	80	48	30	92	54	27	19	6	35	M8	53
6357630	KRP/80 M8x40	80	48	30	92	54	27	19	6	40	M8	55
6357640	KRP/80 M8x50	80	48	30	92	54	27	19	6	50	M8	58
6357660	KRP/80 M10x20	80	48	30	92	54	27	19	6	20	M10	55
6357665	KRP/80 M10x25	80	48	30	92	54	27	19	6	25	M10	58
6357670	KRP/80 M10x30	80	48	30	92	54	27	19	6	30	M10	61
6357680	KRP/80 M10x40	80	48	30	92	54	27	19	6	40	M10	66
6357690	KRP/80 M10x50	80	48	30	92	54	27	19	6	50	M10	71
6357700	KRP/80 M10x60	80	48	30	92	54	27	19	6	60	M10	78
6357720	KRP/80 M12x20	80	48	30	92	54	27	19	6	20	M12	75
6357730	KRP/80 M12x30	80	48	30	92	54	27	19	6	30	M12	82
6357740	KRP/80 M12x40	80	48	30	92	54	27	19	6	40	M12	88
6357750	KRP/80 M12x50	80	48	30	92	54	27	19	6	50	M12	95
6357760	KRP/80 M12x60	80	48	30	92	54	27	19	6	60	M12	102
6358620	KRP/100 M12x30	100	58	36	115	66	30	25	8	30	M12	114
6358630	KRP/100 M12x40	100	58	36	115	66	30	25	8	40	M12	120
6358640	KRP/100 M12x50	100	58	36	115	66	30	25	8	50	M12	126
6358650	KRP/100 M12x60	100	58	36	115	66	30	25	8	60	M12	138
6358660	KRP/100 M12x70	100	58	36	115	66	30	25	8	70	M12	149
6358680	KRP/100 M14x30	100	58	36	115	66	30	25	8	30	M14	142
6358690	KRP/100 M14x40	100	58	36	115	66	30	25	8	40	M14	146
6358700	KRP/100 M14x50	100	58	36	115	66	30	25	8	50	M14	162
6358710	KRP/100 M14x60	100	58	36	115	66	30	25	8	60	M14	170
6358720	KRP/100 M14x70	100	58	36	115	66	30	25	8	70	M14	181
6358740	KRP/100 M16x30	100	58	36	115	66	30	25	8	30	M16	157
6358750	KRP/100 M16x40	100	58	36	115	66	30	25	8	40	M16	170
6358760	KRP/100 M16x50	100	58	36	115	66	30	25	8	50	M16	184
6358770	KRP/100 M16x60	100	58	36	115	66	30	25	8	60	M16	198
6358780	KRP/100 M16x70	100	58	36	115	66	30	25	8	70	M16	210

NOTE: Arancione RAL 2004 colore standard disponibile a magazzino. Si forniscono, per quantità adeguate, in colori diversi e con inserti a misura.
Orange RAL 2004 available on stock. For certain minimum quantities, custom colors and threaded metal studs available upon request.
Naranja RAL 2004 disponible en stock. Por cantidad apropiada, disponible también en colores diferentes y con insertos de distintas medidas.