

## KRPX

### Maniglia a ripresa

### Adjustable clamping lever / Manija ajustable



#### Descrizione

**Perno in acciaio filettato inox AISI 303.**

Threaded stainless steel stud (AISI 303).

Perno de acero inoxidable roscado (AISI 303).

#### Materiale

**Tecnopolimero nero rinforzato con fibre di vetro, finitura opaca.**

Black thermoplastic, glass fiber reinforced, mat.

Termoplástico negro reforzado con fibra de vidrio, acabado mate.

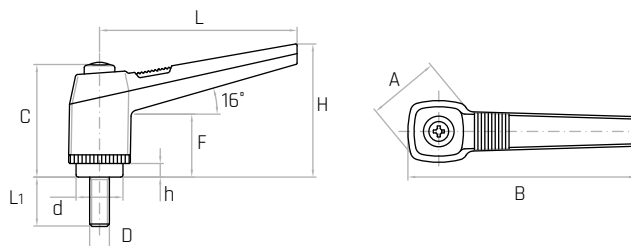

Codice	Modello	L mm	C mm	A mm	B mm	H mm	F mm	d mm	h mm	L1 mm	D	Peso gr.
6386000	<b>KRPX/42 M6x20</b>	42	29	19	50	32	17	12	3	20	<b>M6</b>	15
6386010	<b>KRPX/42 M6x30</b>	42	29	19	50	32	17	12	3	30	<b>M6</b>	16
6386020	<b>KRPX/63 M8x20</b>	63	39	25	73	43	21	15	4	20	<b>M8</b>	33
6386030	<b>KRPX/63 M8x25</b>	63	39	25	73	43	21	15	4	25	<b>M8</b>	34
6386040	<b>KRPX/63 M8x30</b>	63	39	25	73	43	21	15	4	30	<b>M8</b>	36
6386042	<b>KRPX/63 M8x40</b>	63	39	25	73	43	21	15	4	40	<b>M8</b>	39
6386043	<b>KRPX/63 M8x50</b>	63	39	25	73	43	21	15	4	50	<b>M8</b>	40
6386044	<b>KRPX/80 M8x20</b>	80	48	30	92	54	27	19	6	20	<b>M8</b>	49
6386045	<b>KRPX/80 M8x30</b>	80	48	30	92	54	27	19	6	30	<b>M8</b>	52
6386049	<b>KRPX/80 M8x50</b>	80	48	30	92	54	27	19	6	50	<b>M8</b>	59
6386050	<b>KRPX/80 M10x25</b>	80	48	30	92	54	27	19	6	25	<b>M10</b>	58
6386060	<b>KRPX/80 M10x30</b>	80	48	30	92	54	27	19	6	30	<b>M10</b>	61
6386070	<b>KRPX/80 M10x40</b>	80	48	30	92	54	27	19	6	40	<b>M10</b>	66
6386080	<b>KRPX/80 M10x50</b>	80	48	30	92	54	27	19	6	50	<b>M10</b>	71

**NOTE:** Arancione RAL 2004 colore standard disponibile a magazzino. Si forniscono, per quantità adeguate, in colori diversi.

Orange RAL 2004 available on stock. For certain minimum quantities, custom colors available upon request.

Naranja RAL 2004 disponible en stock. Por cantidad apropiada, disponible también en colores diferentes.