



MODELLO NR	F1 (N)	F3 (N)	Fi	ANGOLO (ANGLE) ( ± 5 ° )	PESO (POIDS) (gr ±%2)
			CARICO (CHARGE) ( F1 )		
225 - 4	1500	5000	5:1	120°	1120
225 - 6	2500	6500	5:1	120°	2100

F1: FORZA DI ESERCIZIO ( FORCE EXERCICE ) , F3: CAPACITA' DI TENUTA ( CAPACITE DE MAINTIEN ) , Fi: FORZA APPLICATA ( FORCE APPLIQUEE )

## Base Orizzontale

Base de Montage Horizontale



224-L

Pagina/Page: 30



241

Pagina/Page: 32



224

Pagina/Page: 29

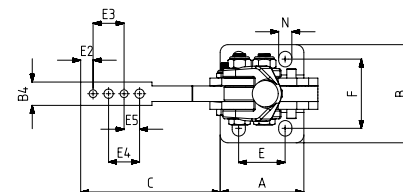
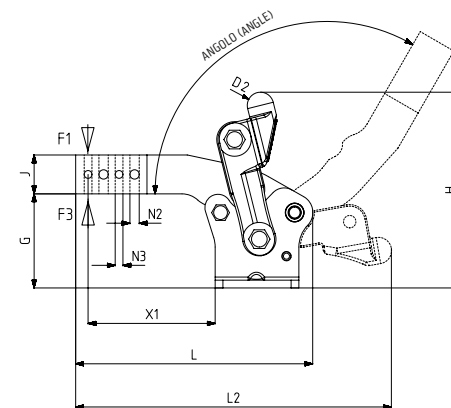

MODELLO NR	A	B	B4	C	D2	E	E2	E3	E4	E5	F	G	H	J	L	L2	N	N2	N3	X1
225 - 4	54	63	15	90	∅ 17	30	8	20	20	10	44,5	60,5	126	25	153	204	8,5 x 10	∅ 6	∅ 6	82
225 - 6	70	74	20	106,5	∅ 22	45	8	30	30	15	52	83,5	159	31	187	263	10,5 x 11,5	∅ 8	∅ 6	98,5