

# PNDX PNDX/C

**Pistoncino a molla**  
**Indexing plunger**  
**Posicionador con resorte**



## Descrizione

**Corpo e puntale in acciaio inox AISI 303.**

Stainless steel body and pin (AISI 303).

Cuerpo y puntera de acero inoxidable (AISI 303).

## Materiale

**Volantino zigrinato in tecnopolimero nero, rinforzato con fibre di vetro, finitura opaca.**

Black thermoplastic knurled knob, glass fiber reinforced, mat.

Volante moleteado de termoplástico negro, reforzado con fibra de vidrio, acabado mate.

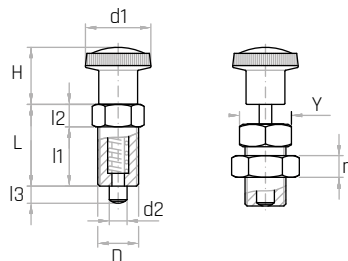
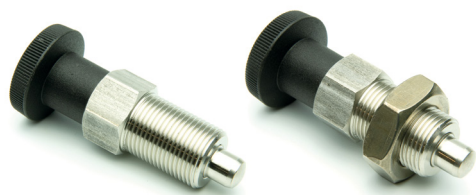

Codice	Modello	d1 mm	H mm	D	L mm	l1 mm	l2 mm	l3 mm	d2 mm	Y mm	m mm	Peso gr.
6395207	PNDX/22	22	18	M10x1	25	16	9	5	5	12	-	22
6395209	PNDX/22	22	18	M10x1	25	16	9	8	5	12	-	25
6395212	PNDX/26	26	23	M12x1,5	29	19	10	6	6	14	-	36
6395214	PNDX/26	26	23	M12x1,5	29	19	10	9	6	14	-	40
6395217	PNDX/32	32	28	M16x1,5	37	25	12	8	8	19	-	77
6395219	PNDX/32	32	28	M16x1,5	37	25	12	12	8	19	-	87
6395224	PNDX/32	32	28	M16x1,5	37	25	12	12	10	19	-	90
6395222	PNDX/32	32	28	M20x1,5	41	27	14	10	10	22	-	121
6395229	PNDX/32	32	28	M20x1,5	41	27	14	15	12	22	-	131
6395208	PNDX/22/C	22	18	M10x1	25	16	9	5	5	12	5	29
6395210	PNDX/22/C	22	18	M10x1	25	16	9	8	5	12	5	32
6395213	PNDX/26/C	26	23	M12x1,5	29	19	10	6	6	14	6	46
6395215	PNDX/26/C	26	23	M12x1,5	29	19	10	9	6	14	6	50
6395218	PNDX/32/C	32	28	M16x1,5	37	25	12	8	8	19	8	95
6395220	PNDX/32/C	32	28	M16x1,5	37	25	12	12	8	19	8	105
6395225	PNDX/32/C	32	28	M16x1,5	37	25	12	12	10	19	8	108
6395223	PNDX/32/C	32	28	M20x1,5	41	27	14	10	10	22	10	151
6395230	PNDX/32/C	32	28	M20x1,5	41	27	14	15	12	22	10	161

**NOTE:** Versione C con controdado in acciaio inox AISI 303.

C version with stainless steel locking nut (AISI 303).

Versión C con contratuerca de acero inoxidable (AISI 303).